

WATER SOURCE CONFIRMATION

ON AUGUST 7TH, 2023 THE BELLA VISTA WATER DEPARTMENT WAS CONTACTED AND STATED THE WATER SHOULD BE SOURCED FROM THE SHARED LOT LINE.

LAND SURVEYOR'S CERTIFICATION

I HEREBY CERTIFY THAT ON THE 27TH DAY OF JULY, 2023 THE HEREON PLATTED AND DESCRIBED SURVEY WAS COMPLETED UNDER MY SUPERVISION AND THE IRON PINS WERE FOUND OR SET, AS SHOWN ON THIS PLAT, ALL EASEMENTS AND ENCROACHMENTS REVEALED BY THE SURVEY ARE AS SHOWN ON THIS PLAT.

DAVID B. PLATZ, R.L.S. #1553

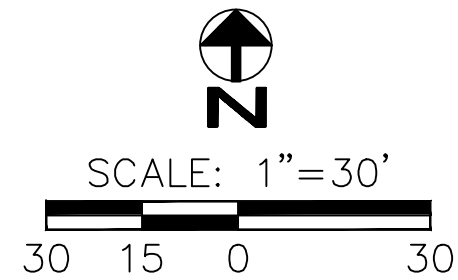

LEGEND

- F.I.P. FOUND IRON PIN
- S.I.P. SET IRON PIN
- P.O.T. POINT OF TANGENT
- ⊕ POWER POLE
- BUILDING SETBACK
- EASEMENT LINE
- TOPOGRAPHY
- PROPOSED TOPOGRAPHY
- LIMITS OF DISTURBANCE
- OVERHEAD ELECTRIC
- ⊕ PROP. WATER METER
- XXX.XX GRADE ELEVATION
- ▲ HIGH POINT
- ⊕ BENCHMARK
- ⊕ TELEPHONE PEDESTAL
- ⊕ CABLE PEDESTAL
- ⊕ EX WATER BLOW-OFF
- ⊕ WATER VALVE

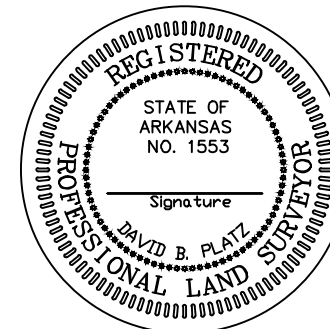

PROPERTY DESCRIPTION

LOTS 12 & 13, BLOCK 3, WEEDON SUBDIVISION BELLA VISTA, ARKANSAS.

THIS LOT LIES IN THE SW ¼ OF THE NW ¼ OF SECTION 21, T-21-N, R-30-W.

LOT 12 AREA: 0.384 ACRES
LOT 13 AREA: 0.375 ACRES

THE TAX PARCEL #: 16-31394-000 & 16-31395-000

ZONING: RESIDENTIAL

THE BASIS OF BEARINGS FOR THIS SURVEY IS THE SUBDIVISION PLAT.

SEWAGE DISPOSAL SYSTEM NOTES

1. MAXIMUM SOIL ABSORPTION TRENCH DEPTH SHALL BE 18".
2. EACH SOIL ABSORPTION TRENCH MUST BE INSTALLED ON CONTOURS AS DESIGNED AND MUST NOT BE ALTERED TO AVOID EXISTING TREES, PROPOSED LANDSCAPING, STORAGE BUILDINGS, OR OTHER OBSTRUCTIONS WITHOUT CONTACTING THE BELLA VISTA A.C.C. OFFICE AT (479) 855-8080.
3. MINIMUM 6" OF SOIL COVER OVER TRENCH GRAVEL.
4. TOPSOIL AND SEEDING WITH GRASS RECOMMENDED.
5. EACH TRENCH MUST BE EXCAVATED BY BACKHOE TO PREVENT COMPACTION OF TRENCH BOTTOM.
6. FINAL GRADE OVER THE SOIL ABSORPTION AREA SHALL BE SUCH THAT ALL SURFACE WATER WILL DRAIN OFF AND AWAY FROM THE SYSTEM. IMPROPER GRADING MAY CAUSE THE SYSTEM TO NOT FUNCTION PROPERLY.
7. ALL TIGHTLINES ARE TO BE SCHEDULE 40 AND ALL PERFORATED PIPE SHALL BE ASTM 2729 OR F-810.

NOTICE: THIS IS ONLY A PLAN AND DOES NOT NECESSARY REFLECT THE ACTUAL SIZE, SHAPE OF LOCATION OF ANY IMPROVEMENTS ON THE LOT.

THIS SEPTIC PLAN HAS BEEN DESIGNED IN COMPLIANCE WITH THE RULES AND REGULATIONS PERTAINING TO SEWAGE DISPOSAL SYSTEMS AS PROVIDED IN ACT 402 OF 1977. THIS IN NO WAY GUARANTEES THAT THIS SYSTEM WILL FUNCTION PROPERLY.

DATED: _____ BY: _____
DESIGNATED REPRESENTATIVE

THE INDIVIDUAL SEWAGE DISPOSAL SYSTEM OR SANITARY CONNECTION HAS BEEN APPROVED FOR CONSTRUCTION AS SHOWN. THIS APPROVAL DOES NOT CONSTITUTE A GUARANTEE THAT THE SYSTEM WILL FUNCTION PROPERLY.

DATED: _____ BY: _____
AUTHORIZED AGENT (HEALTH DEPT.)

**WEEDON SUBDIVISION
LOTS 12 & 13, BLOCK 3
BELLA VISTA, ARKANSAS**

SEPTIC PLAN		REVISIONS	
		No.:	DATE:
OWNER: JOHN THROWER			
DRAWN BY: DP/ZS		DATE: 8/9/23	
CHECKED BY:		JOB No.:	2023268
		SCALE:	SHEET:
P.O. BOX 223 BENTONVILLE, AR 72712		1"=30'	1