

**SEWAGE DISPOSAL SYSTEM NOTES**

1. MAXIMUM SOIL ABSORPTION TRENCH DEPTH SHALL BE 18".
2. EACH SOIL ABSORPTION TRENCH MUST BE INSTALLED ON CONTOURS AS DESIGNED AND MUST NOT BE ALTERED TO AVOID EXISTING TREES, PROPOSED LANDSCAPING, STORAGE BUILDINGS, OR OTHER OBSTRUCTIONS WITHOUT CONTACTING THE BELLA VISTA A.C.C. OFFICE AT ( 479 ) 855-8080.
3. MINIMUM 6" OF SOIL COVER OVER TRENCH GRAVEL.
4. TOPSOIL AND SEEDING WITH GRASS RECOMMENDED.
5. EACH TRENCH MUST BE EXCAVATED BY BACKHOE TO PREVENT COMPACTION OF TRENCH BOTTOM.
6. FINAL GRADE OVER THE SOIL ABSORPTION AREA SHALL BE SUCH THAT ALL SURFACE WATER WILL DRAIN OFF AND AWAY FROM THE SYSTEM. IMPROPER GRADING MAY CAUSE THE SYSTEM TO NOT FUNCTION PROPERLY.
7. ALL TIGHTLINES ARE TO BE SCHEDULE 40 AND ALL PERFORATED PIPE SHALL BE ASTM 2729 OR F-810.

NOTICE: THIS IS ONLY A PLAN AND DOES NOT NECESSARY REFLECT THE ACTUAL SIZE, SHAPE OF LOCATION OF ANY IMPROVEMENTS ON THE LOT.

THIS SEPTIC PLAN HAS BEEN DESIGNED IN COMPLIANCE WITH THE RULES AND REGULATIONS PERTAINING TO SEWAGE DISPOSAL SYSTEMS AS PROVIDED IN ACT 402 OF 1977. THIS IN NO WAY GUARANTEES THAT THIS SYSTEM WILL FUNCTION PROPERLY.

DATED: \_\_\_\_\_ BY: \_\_\_\_\_  
DESIGNATED REPRESENTATIVE

THE INDIVIDUAL SEWAGE DISPOSAL SYSTEM OR SANITARY CONNECTION HAS BEEN APPROVED FOR CONSTRUCTION AS SHOWN. THIS APPROVAL DOES NOT CONSTITUTE A GUARANTEE THAT THE SYSTEM WILL FUNCTION PROPERLY.

DATED: \_\_\_\_\_ BY: \_\_\_\_\_  
AUTHORIZED AGENT (HEALTH DEPT.)

**LINDSEY SUBDIVISION  
LOTS 15 & 16, BLOCK 5  
3 KEAL LANE  
BELLA VISTA, ARKANSAS**

**PROPERTY DESCRIPTION**

LOTS 15 & 16, BLOCK 5, LINDSEY SUBDIVISION BELLA VISTA, ARKANSAS.

THESE LOTS LIE IN THE SE ¼ OF THE NW ¼ OF SECTION 17, T-21-N, R-30-W.

LOT 15 AREA: 0.300 ACRES  
LOT 16 AREA: 0.392 ACRES

THE TAX PARCEL #: 16-19635-000 & 16-19636-000

ZONING: RESIDENTIAL

THE BASIS OF BEARINGS FOR THIS SURVEY IS THE SUBDIVISION PLAT.

**GRADING NOTES**

FINAL GRADE, CUT OR FILL SLOPES SHALL HAVE A FINISH GRADE NO STEEPER THAN 33 PERCENT. (SEC. 107-380 (c)(1)) FILL SHALL NOT BE PLACED ON EXISTING SLOPE WITH A GRADE STEEPER THAN 15 PERCENT UNLESS KEYED INTO STEPS IN EXISTING GRADE AND THOROUGHLY STABILIZED BY MECHANICAL COMPACTION. (SEC. 107-380 (e)(3))

**WATER SOURCE CONFIRMATION**

ON AUGUST 7TH, 2023 THE BELLA VISTA WATER DEPARTMENT WAS CONTACTED AND STATED THE WATER SHOULD BE SOURCED FROM THE SHARED LOT LINES OF THESE LOTS.

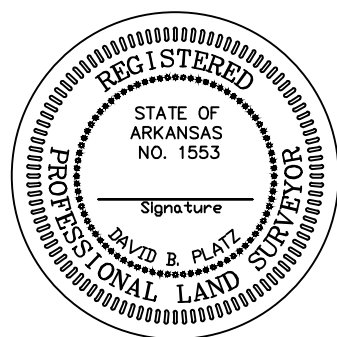

**LAND SURVEYOR'S CERTIFICATION**

I HEREBY CERTIFY THAT ON THE 26TH DAY OF JULY, 2023 THE HEREON PLATTED AND DESCRIBED SURVEY WAS COMPLETED UNDER MY SUPERVISION AND THE IRON PINS WERE FOUND OR SET, AS SHOWN ON THIS PLAT, ALL EASEMENTS AND ENCROACHMENTS REVEALED BY THE SURVEY ARE AS SHOWN ON THIS PLAT.

DAVID B. PLATZ, R.L.S. #1553

SEPTIC PLAN	REVISIONS		
	No.:	BY:	DATE:
OWNER: JOHN THROWER			
DRAWN BY: DP/ZS			DATE: 8/9/23
CHECKED BY:			JOB No.: 2023263
273-7989 OR 366-7989			SCALE: 1"=30'
CONSULTING INC. P.O. BOX 223 BENTONVILLE, AR 72712			SHEET: 1